

1:60 SCALE
PAPER
MODEL
KIT



Prototype defensive mobile suit OZ-MSX2 MERCURIUS Ver. tos-craft premium

**tos
craft**
premium

peri
www.perikertas.com

Print out list

Mobile suit : [A] Red 7pages, [B] Black 3pages, [C] Silver, 1page [D] White 1page.

Weapons : [a] Black 4pages, [b] Yellow 1 page.

- Catatan: Ada banyak part yang berukuran kecil. Akan lebih baik jika menggunakan cutter/cutterpen, pinset, superglue(lemsuper), kertas tebal(untuk melapisi), atau material lain pada bagian yang diperlukan.
- Apabila ingin mengajukan pertanyaan, complain seputar desain silakan menghubungi www.facebook.com/ToscrafterPremium.

1 Head part

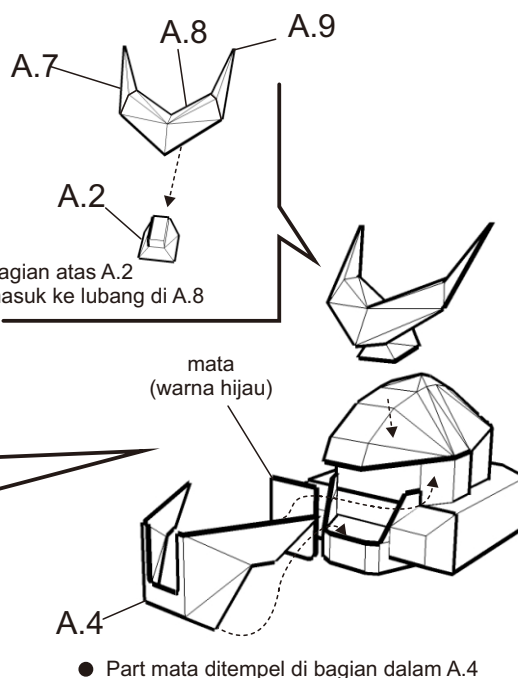
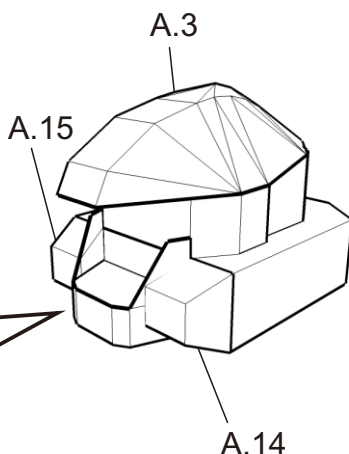
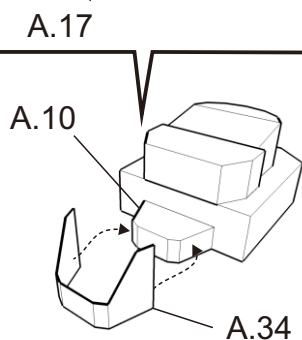
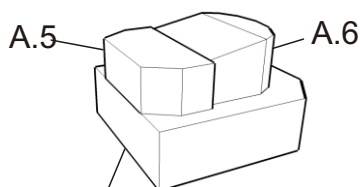

© 2013 Tosan Aji Prakoso

2 Body part

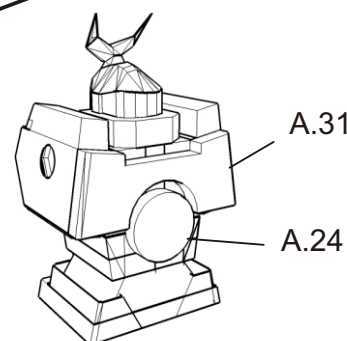
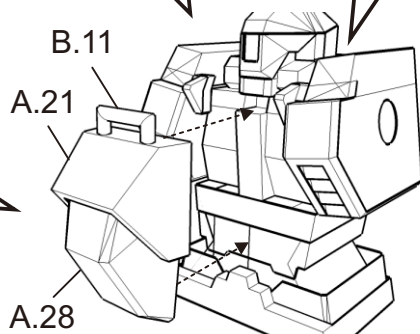
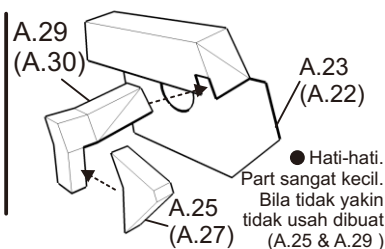
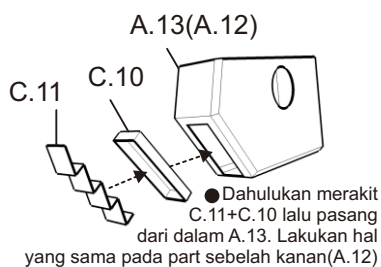
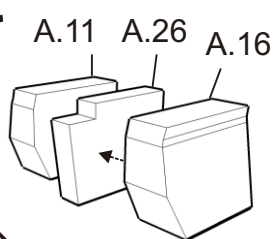
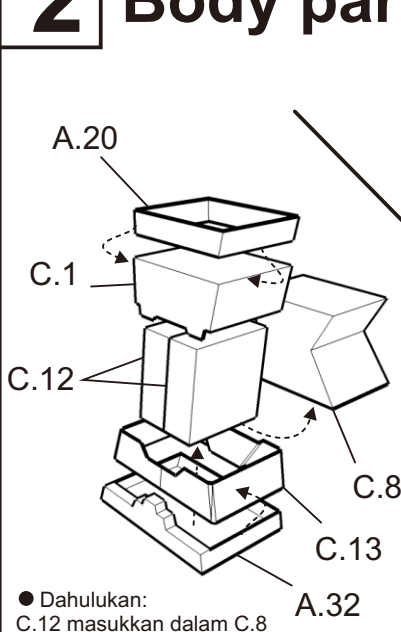

© 2013 Tosan Aji Prakoso

3 Leg part

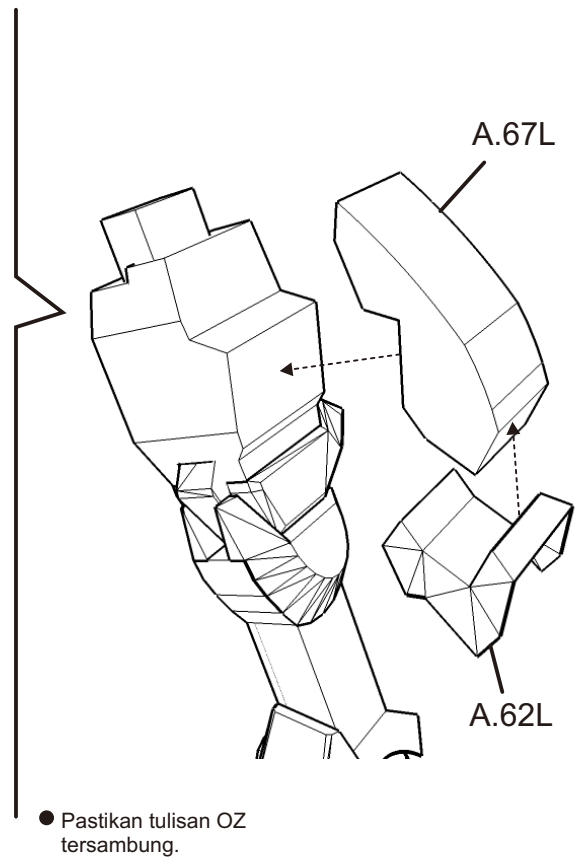
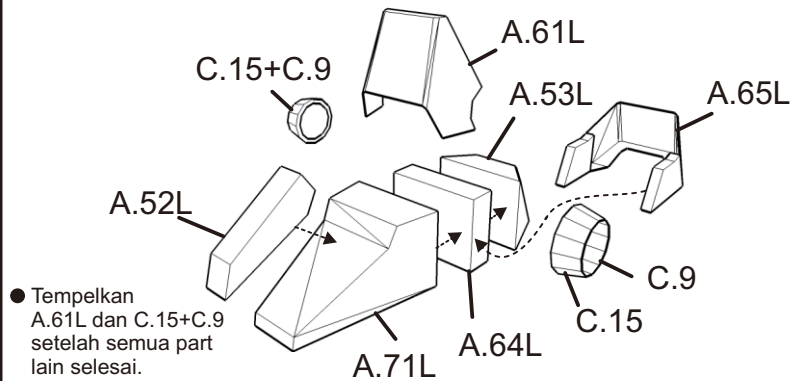
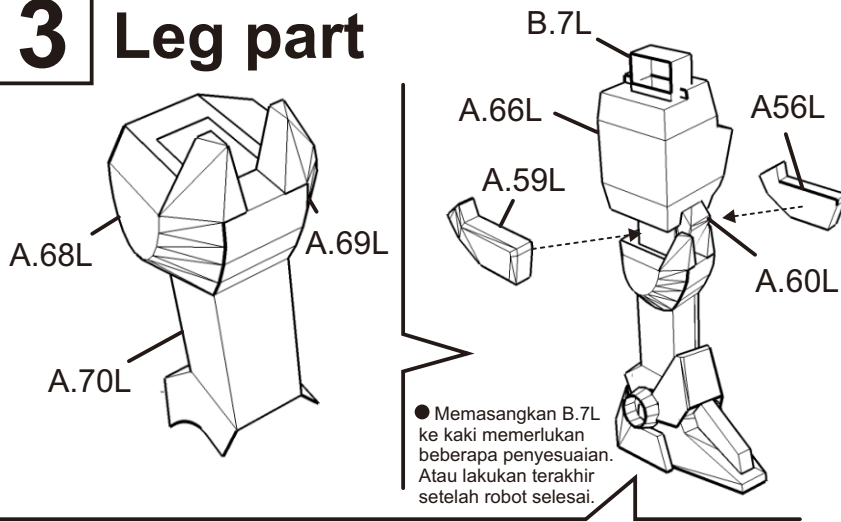

4 Hand part

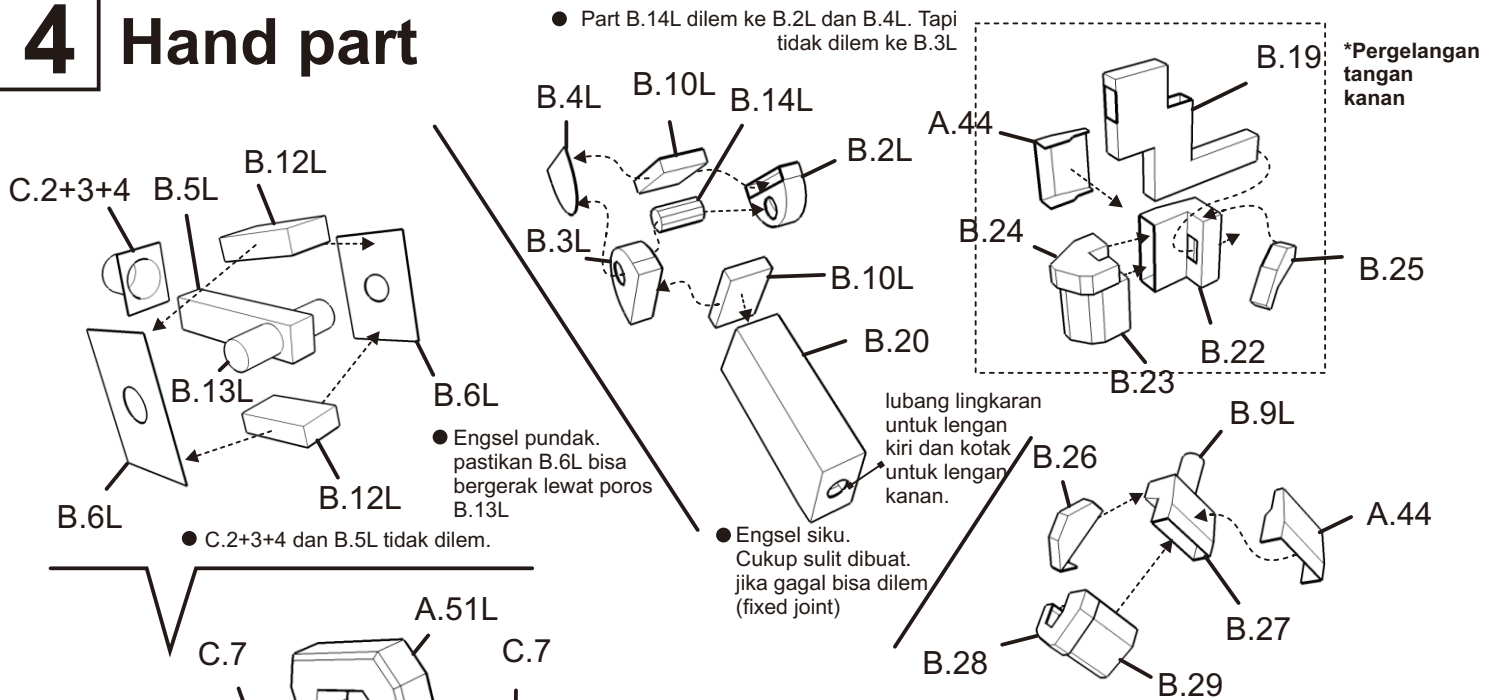

5 Waist part

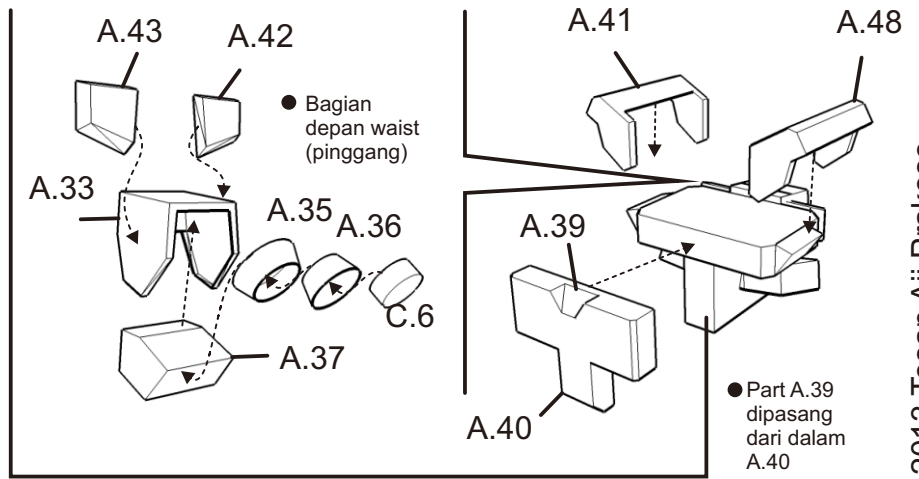
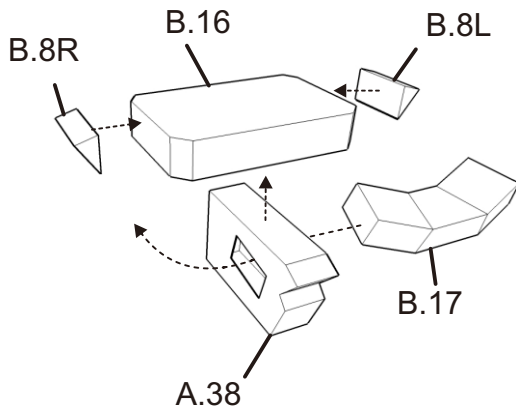

© 2013 Tosan Aji Prakoso

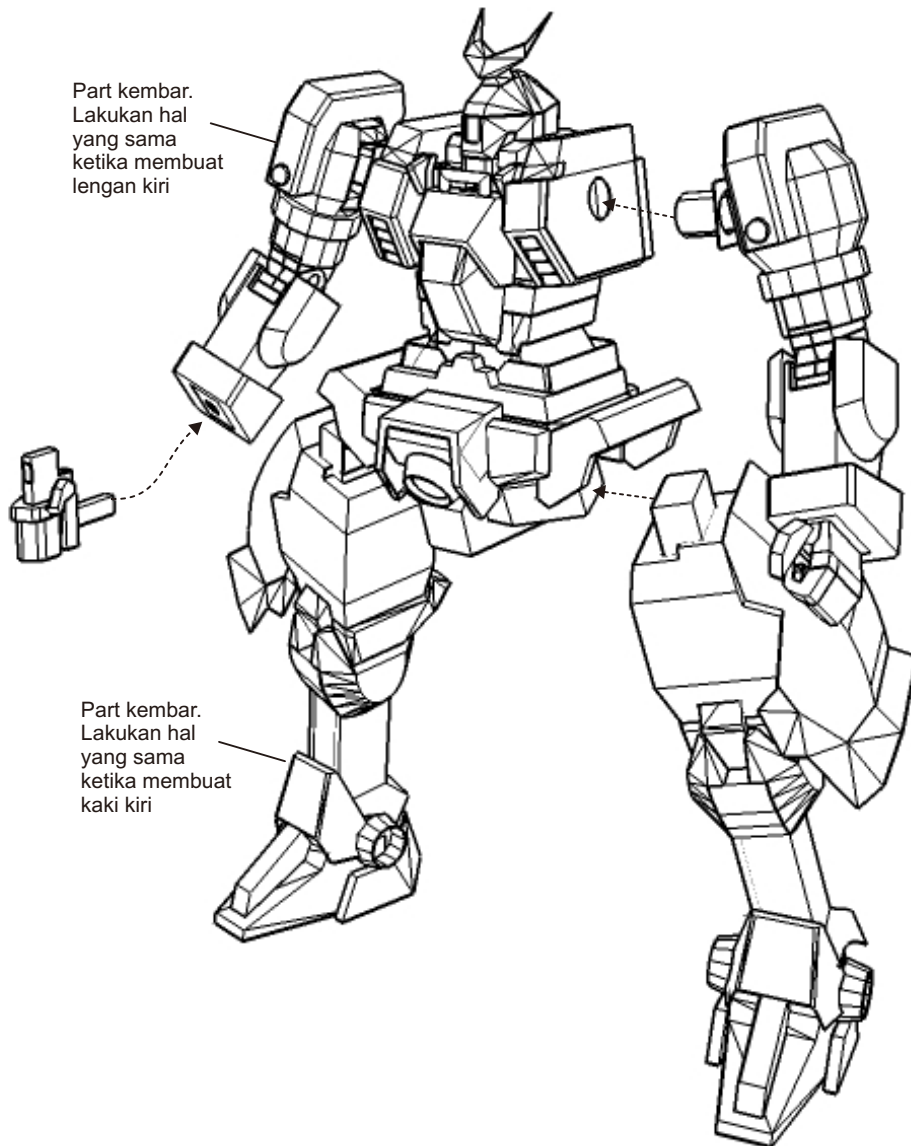

© 2013 Tosan Aji Prakoso

- Untuk referensi atas model yang sudah jadi, silakan lihat di <http://www.facebook.com/ToscraftPremium>
- Untuk diskusi mengenai papercraft dan bertemu papercrafter lain se-Indonesia silakan bergabung dengan komunitas PERIKERTAS Facebook group di <http://www.facebook.com/groups/perikertas> dan official website di <http://www.perikertas.com/>

6 Beam Gun

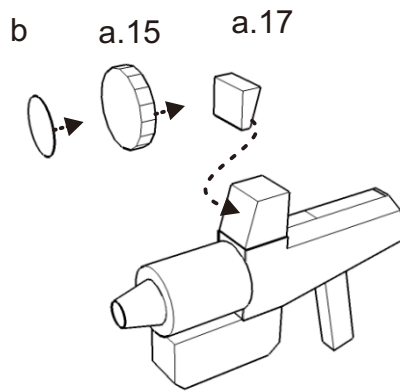
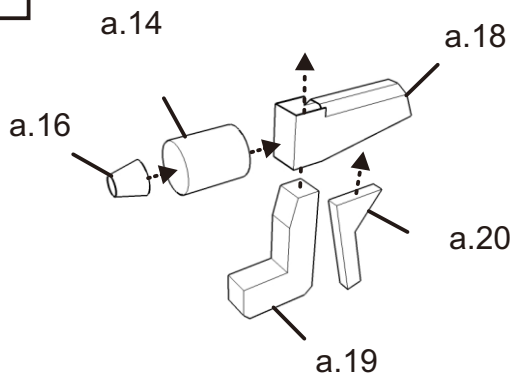

© 2013 Tosan Aji Prakoso

7 Crash Shield

- Part a.8 ditempel terakhir setelah part a.4 dan a.3 telah disatukan.

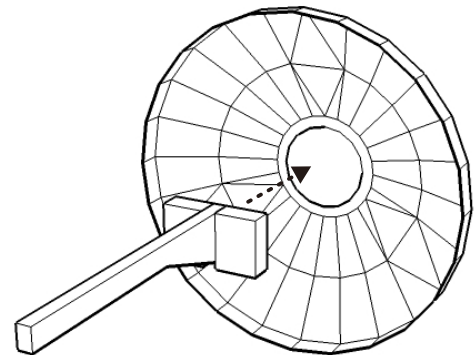
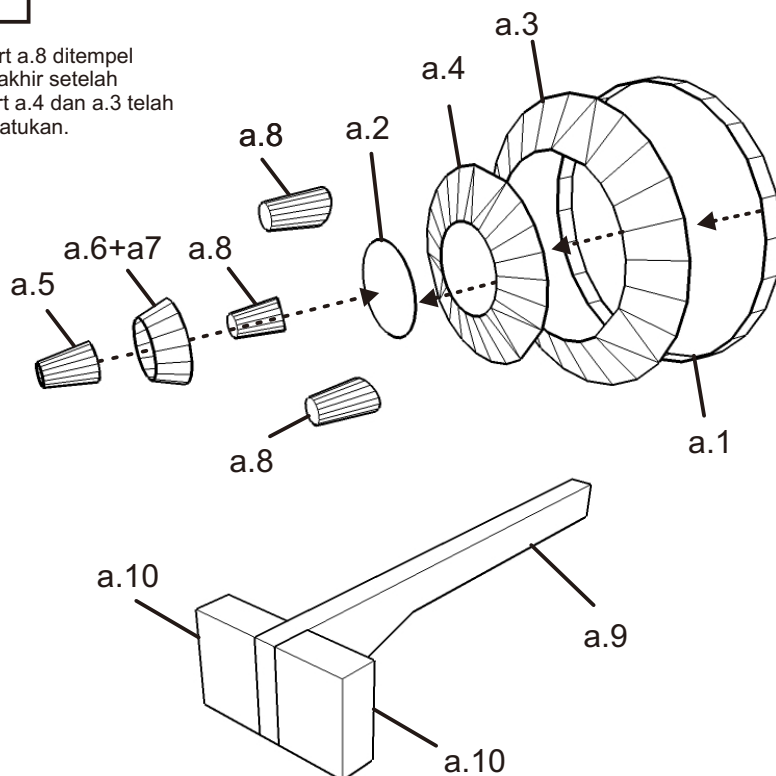

© 2013 Tosan Aji Prakoso

8 Planet Defenders

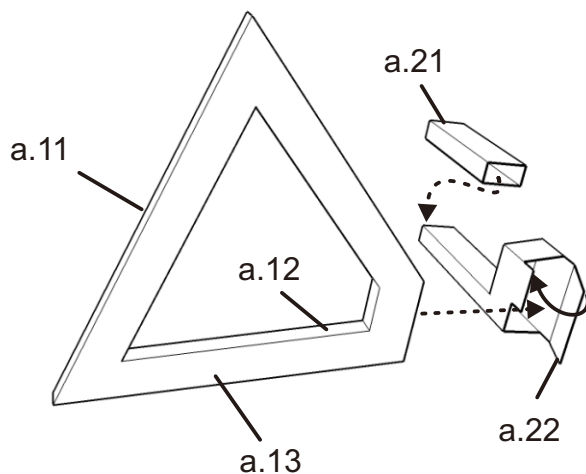

- Part a.21 memungkinkan untuk planet defenders dilepas-pasang, jadi usahakan cukup longgar untuk dimasuki part a.22. Bila tidak diinginkan cukup tempelkan a.22 ke body part. cek gambarnya di facebook page tos-craft premium.

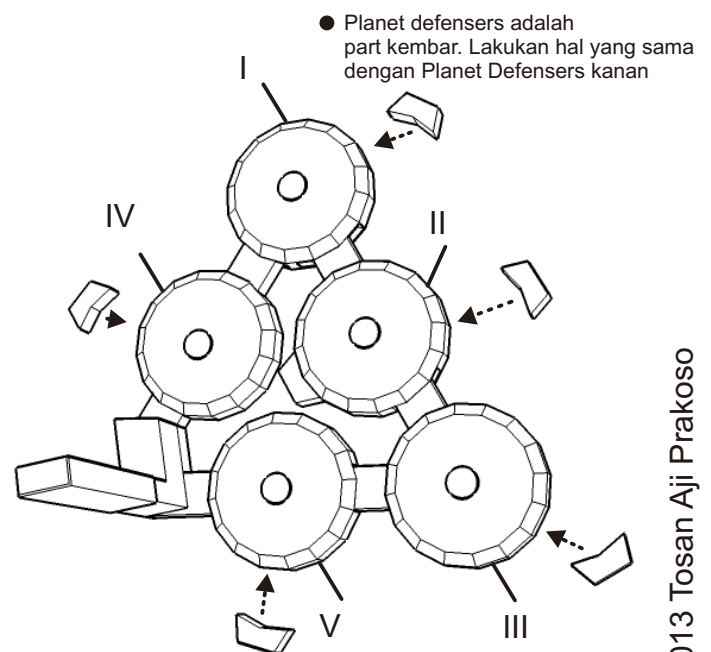

- Planet defenders adalah part kembar. Lakukan hal yang sama dengan Planet Defenders kanan
- Merakit part I-V memerlukan kesabaran. rakit separuh bagian, lalu selipkan part penopang yang berbentuk segitiga, lalu rakit sisanya.

© 2013 Tosan Aji Prakoso